

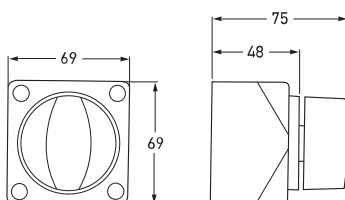



## Battery Master Switch

Suitable for cars and medium sized trucks.  
Complete with removable key.



<b>Part Number</b>	<b>4640</b>		<b>OFF-ON</b>
Mounting	Recess or surface mount.		
Maximum Load	12/24V	1250A for up to 10 seconds	
Maximum Continuous Load	12/24V	275A	
Termination	2 x M10 studs.		
Spare Part	4641	Spare key	