

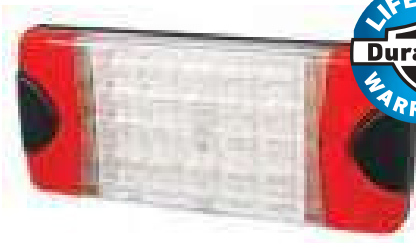

## DuraLED® Combi-S Stop/Rear Position/Rear Direction Indicator Lamp - Heavy Duty

DuraLED® combination lamp featuring Ultra Wide Visibility Optics for significantly improved side visibility and Enhanced Definition Technology (EDT). Suitable for commercial vehicles and boat trailers. Shockproof and fully sealed to withstand water submersion and high-pressure washing. Optic appears clear until illuminated.

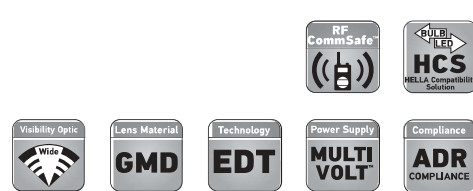
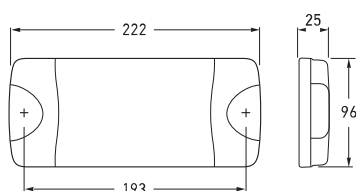

P/N 2378-BL

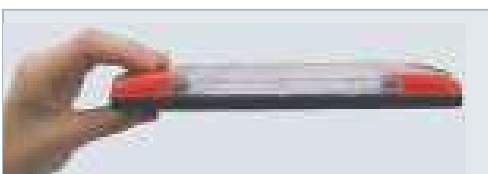

Ultra slim height of only 25mm.

|             |             |                     |
|-------------|-------------|---------------------|
| Part Number | 2378        |                     |
|             | 2378-BL     | BLISTER PACK        |
|             | 2378-BULK   | PACK OF 12          |
|             | 2378-CS     | HCS TECHNOLOGY      |
|             | 2378-6M     | 6M CABLE            |
|             | 2378-6MBULK | 6M CABLE PACK OF 12 |

|                   |  |                        |   |
|-------------------|--|------------------------|---|
| Mounting          | Surface mount with mounting bushes supplied. Suitable for horizontal or vertical mounting.   |                        |   |
| Voltage           | Multivolt™ for optimum brightness in 12 and 24 volt systems.   |                        |   |
| Power Consumption | Stop: 5W   | Rear position: 1W      | Rear direction indicator: 5W            |
| Protection        | Reverse polarity and 5000 watt Transient Voltage Suppressor (TVS).<br>IP 6K7 (Protection against dust and temporary water immersion)<br>IP 6K9K (Protection against dust and high-pressure/steam jet cleaning) |                        |   |
| Cable Length      | P/Ns 2378/...-BL/...-BULK/...-CS Pre-wired with 2.5m of sheathed multi-core cable<br>P/Ns 2378-6M/...-6MBULK Pre-wired with 6m of sheathed multi-core cable  |                        |   |
| Lens Material     | High impact and chemical resistant Grilamid® lens  |                        |   |
| Compliance        | ADR 6/00: Cat 2a<br>E24 5883   | ADR 49/00<br>ECE R6/01 | ISO 13207-1 (2378-CS only)<br>ECE R7/02 |

See page 80 for DuraLED® accessories. See page 20 for further information on HCS Technology and ISO 13207-1.

### COMBI-S LAMP FUNCTIONS



Stop

Rear position

Rear direction indicator