

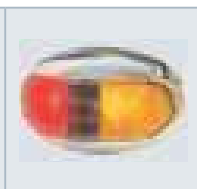

## DuraLED® Side Marker Lamp

Red/amber side marker LED lamp.  
Optic appears clear until illuminated.

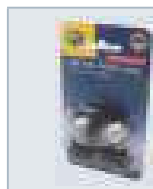
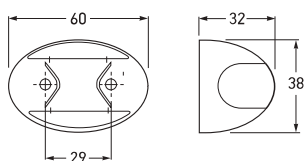

P/N 2053

P/N 2053CHROME

Part Number	2053	
	2053-BULK	PACK OF 4
	2053CHROME	CHROME PLATED
Mounting	Surface mount.	
Voltage	Multivolt™ for optimum brightness in 12 and 24 volt systems.	
Power Consumption	<1W	
Protection	Reverse polarity protection. IP 6K6 (Protection against dust and high-pressure water jets) IP 6K7 (Protection against dust and temporary water immersion)	
Cable Length	Pre-wired with 0.5m of sheathed multi-core cable. Bulk pack pre-wired with 2.5m of sheathed multi-core cable.	
Spare Part	9,2053.08	Black nylon housing
Compliance	ADR 45/01	
See pages 81-82 for DuraLED® marker lamp accessories.		