

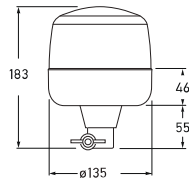



RotaLED Beacon - Pipe Mount

RotaLED Beacon, with the latest LED technology provides an optimum signal image with low power consumption featuring rotating LED light function. The combination of thermal management and optics in one module makes a remarkably compact design possible. Impact and dirt resistant Polycarbonate lens.



Part Number	1612	AMBER
Mounting	Pipe Mounting. Tubular base incorporates connection plug. Must be used in conjunction with connecting piece P/N 8007, or other HELLA 2-pole beacon mounts.	
Voltage	Multivolt™ for optimum brightness at input voltages from 10 to 32 volts	
Power Consumption	10W	
Protection	Same as P/N 1611 above	
Flash Rate	Simulated rotation 120-133rpm (2,0-2,2 Hz)	
Cable Length	Pre-wired with 120mm cable	
Accessories	8007 2 Pole beacon mount - Pipe 8007FM 2 Pole beacon mount - Flat mount 8007RA 2 Pole beacon mount - Flat angle mount 8008 2 Pole beacon mount - Threaded mount	
RF Suppression	CISPR25 Class 5	
Compliance	ECE R65/00 TA1	ECE R10 



P/N 8007

P/N 8007FM

P/N 8007RA

P/N 8008