

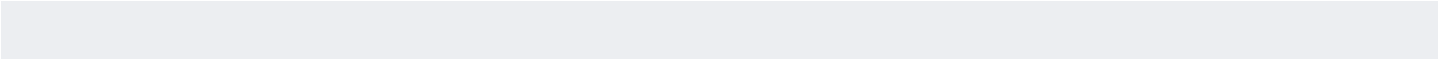

In today's fast paced world safety is of paramount concern to all sectors of industry.

Our safety lighting solutions lead in both quality, reliability and value to ensure trusted performance in the most challenging of environments – all supported by the TWL team New Zealand-wide.



Copyright © TWL. The illustrations, information and specifications contained within this catalogue remain the property of TWL. No part of this catalogue may be reproduced in whole or in part without prior approval. While all care has been taken by all persons involved in the compiling and production of this catalogue, no responsibility for errors, omissions or variations will be accepted. Photography, descriptions and references are subject to change without prior warning.

## BEACON &amp; LIGHTBAR RANGE SUMMARY

## Safety Beacons

Series:	Part No.	Type:	Style:	Flash Pattern:	Mounting:	Volts:	Approvals:	Page:
ECCO 7660	7660A	LED	Rotator	75 or 125 FPM	3-Bolt	12-24	SAE J845 Class 1, CE, R10, R65, ROHS, IP67	F2
ECCO 5800	5800A	Bulb	Rotator	-	DIN Pole	12-24*	SAE J845 Class 1, CE, R10, R65	F3
	5803A	Bulb	Rotator	-	3-Bolt	12-24*	SAE J845 Class 1, CE, R10, R65	F3
	5807A-VM	Bulb	Rotator	-	Magnetic	12-24*	SAE J845 Class 1, CE, R10, R65	F3
ECCO 6465	6465A	LED	Pulse	80 FPM	3-Bolt	12-80	SAE J845 Class 3, CE, R10, UL, RoHS	F4
ECCO 6262	6262A	LED	Pulse	80 FPM	2-Bolt	12-80	SAE J845 Class 3, CE, R10, UL, RoHS, IP66/67	F4
ECCO 7980	7980A	LED	Pulse	11 Options	3-Bolt	12-24	SAE J845 Class 1, CE, R10, ROHS, IP56	F5
ECCO 400	V11050	LED	Pulse	8 Options	3-Bolt	10-30	ECE Reg 65, ECE R10, IP65	F5
	V11053	LED	Pulse	8 Options	Magnetic	10-30	ECE Reg 65, ECE R10, IP65	F5
Britax BF300	BF305-00	LED	Pulse	4 Options	DIN Pole	10-30	SAE J845 Class 1, ECE R10, IP67	F5

\*12-24 Volt with bulb change (the bulb is supplied separately). / FPM = flashes per minute

## Lightbars

Series:	Part No.	Width:	Type:	Flash Pattern:	Mounting:	Volts:	Approvals:	Page:
ECCO Reflex 5585	5585A	381 mm	LED	18 Options	4-Bolt	12-24	SAE J845 Class I, CE, R10, IP65	F6
	5585A-VM	381 mm	LED	18 Options	Magnetic	12-24	SAE J845 Class I, CE, R10, IP65	F6
Optilux MLB100	7MLB100	248 mm	LED	23 Options	4-Bolt	12-24	SAE Class 1, ECE R65, IP65	F7
	7MLB100-MAG	248 mm	LED	23 Options	Magnetic	12-24	SAE Class 1, ECE R65, IP65	F7

## LED ROTATOR BEACON

## 7660 Series LED Rotator Beacon SAE Class 1

Combines the major benefits of LED technology with the unmistakable warning signal of a rotator, all without compromising reliability. LED hybrid technology uses a brushless magnetic drive system to spin the reflector disk, reducing noise and eliminating the typical motor/gear drawbacks associated with conventional rotators. It also features 8 high-intensity LEDs and a TIR optic to provide SAE Class I light output.

- UV hard coated amber lens to greatly reduce cracking, hazing, abrasion and fading
- 1 Flash pattern, 2 rotating speeds; 70 at 75FPM and 120 at 125FPM
- LED hybrid technology provides a high intensity rotating warning signal with no gears, brushes or bulbs to wear out
- 3-Bolt mount
- 12-24 Volt
- 159 H x 166 W (mm)
- Approvals: SAE J845 Class 1, CE, R10, R65, IP67, ROHS
- Spares: R7660LA Replacement Amber Lens  
Part No. 7660A

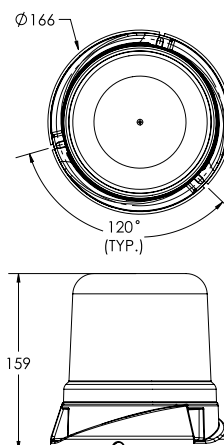

Hella safety lighting is available from TWL. Check out the range online at [www.hella.co.nz](http://www.hella.co.nz)





## BULB ROTATOR BEACONS

### 5800 Series Bulb Rotator Beacons SAE Class 1

Economical rotating beacon that produces SAE Class I light output. A smooth and quiet belt drive module with stainless steel bearings provides long life and reliable service. The reflectors free-form optical design maximizes light output and beam spread.

- 3-Bolt, Flexi-Base & Magnetic mount options
- Rotating bulb. Amber lens
- 12 or 24 Volt with bulb change (bulb supplied separately)
- Approvals: SAE J845 Class 1, CE, R10, R65

#### Bulb Selection & Spares:

- C1255 12 Volt, 55 Watt Halogen Bulb
- C2470 24 Volt, 55 Watt Halogen Bulb
- R5840LA Replacement Amber Lens



#### DIN Pole Mount

Flexi-Base helps resist vibration & protects against minor impacts  
Part No. 5800A

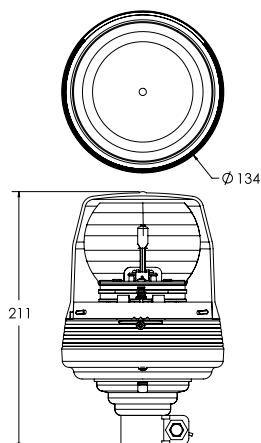

## POLE MOUNT ACCESSORIES



#### Weld-On Pole Mount Bracket

Suits DIN type pole mount beacon.  
Part No. 100.057

#### 3-Bolt Mount

Part No. 5803A

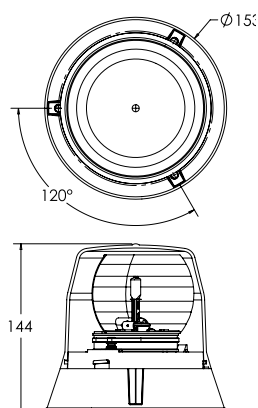

#### Magnetic Mount

4500mm cord with switch lighter adaptor  
Part No. 5807A-VM

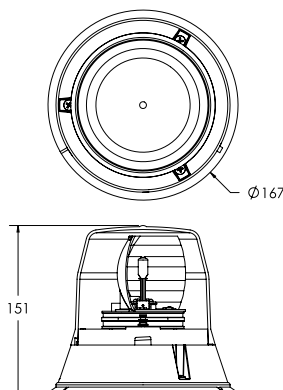

## LED PULSE BEACONS

## 6465A LED Pulse Beacon SAE Class 3

This maintenance free LED beacon a warning signal ideally suited to industrial applications. The long, maintenance-free service life of LED technology, makes this a perfect replacement solution for existing strobe beacons. This cost-effective light features a wide 12-80V operating range that also makes it ideal for use on electrically-powered vehicles and equipment.

- Flash pattern 80 per minute
- Reinforced-nylon base and amber polycarbonate lens
- 3 Bolt mount
- 12-80 Volt
- 100 H x 130 W (mm)
- Approvals: SAE J845 Class 3, CE, R10, UL, RoHS
- Spares: R6400LA Replacement amber lens  
Part No. 6465A

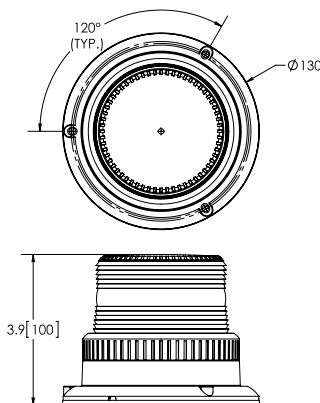

## 6262A LED Pulse Beacon SAE Class 3

This maintenance-free LED beacon produces a warning signal ideally suited to industrial applications. This cost effective unit has a wide operating range of 12-80V, making it the perfect light for use on electric vehicles. The long, trouble-free service life and low amp draw characteristics of LED technology make this an ideal replacement solution for rotating or strobe beacons.

- Flash pattern 80 per minute
- Reinforced nylon base with epoxy-sealed electronics provides superior environmental protection
- Thread-on amber polycarbonate lens
- 2 Bolt mount
- 12-80 Volt
- 124 H x 98 W (mm)
- Reverse polarity, voltage spike and surge protected
- Approvals SAE J845 Class 3, CE, R10, UL, RoHS, IP66/67
- Spares: R6260LA Replacement amber lens  
Part No. 6262A

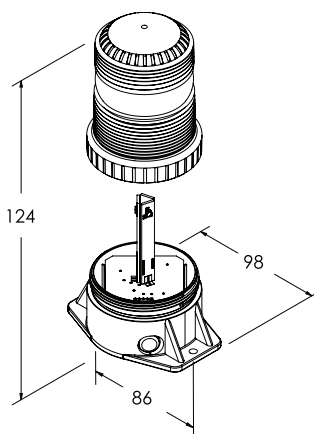

## LED PULSE BEACONS

### 7980A LED Pulse Beacon SAE Class 1



Features encapsulated electronics to provide enhanced protection against dust and moisture ingress and are ideally suited to severe vibration applications including mining, construction and waste management. Offering SAE Class I light output, a choice of 11 flash patterns and 12-24 VDC operation these heavy duty beacons also feature a robust aluminium base. A long maintenance free service life and low amp draw make this beacon a cost effective choice for new installations or for replacing strobe or rotating beacons with the latest technology to eliminate ongoing maintenance.

- 11 flash patterns
- Encapsulated electronics provide enhanced protection against dust, moisture and vibration
- Epoxy-filled, reinforced aluminum base, suitable for heavy-duty applications
- 12-24volt
- 124mm H x 165mm W
- Reverse polarity, voltage spike and surge protected
- Approvals: SAE J845 Class 1, CE, R10, IP56, ROHS
- Spares: R6050LA Replacement Amber Lens

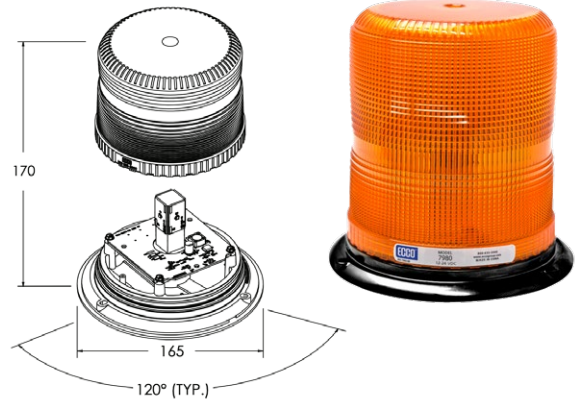

Part No. 7980A

### 400 Series LED Pulse Beacons



The popular 400 Series LED beacons feature 12 LEDs arranged to produce a 360-degree simulated rotate flash pattern, with a flash rate of 120 flashes per minute for maximum visibility. Combining the maintenance free and long life LED technology with a proven tough housing design. This beacon series is designed to maximise resilience to excessive vibration and increase the life of the product.

- 2 popular mounting options; 3-Bolt and Magnetic Mount
- 8 User selectable flash patterns including simulated rotate (120 FPM) single and double flash
- 10-30 Volt
- Amber lens
- Approvals ECE Reg 65, IP65, ECE R10 (emc)

Spares: 910.131 Replacement Amber Lens

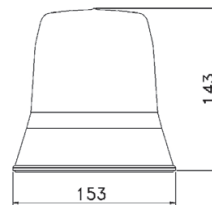

3-Bolt Mount Part No. V11050

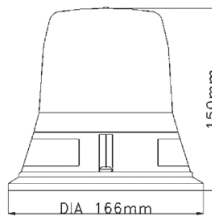

Magnetic Mount Part No. V11053



### BF305-00 LED Pulse Beacon SAE Class 1



The Britax BF300 series LED beacon features powerful high intensity LED output packed into a very rugged die-cast alloy based beacon. Four selectable flash patterns include simulated rotate, single flash, double flash and quadruple flash. This beacon is very robust with high dust, moisture and vibration resistance (IP67).

- Polycarbonate amber lens
- 4 User selectable flash patterns
- 6 high output LEDs
- Flexi pole mount / DIN pole suitable
- 10-30 Volt
- 242 H x 132 W (mm)
- Approvals: SAE J845 Class 1, ECE R10, IP67
- Spares: BF180A Replacement Amber Lens

Part No. BF305-00

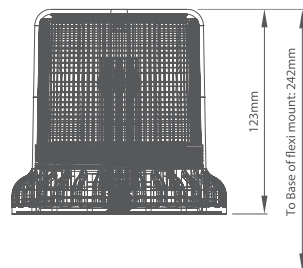

## LED LIGHTBARS

## REFLEX 5585A LED Light Bar 15" - Permanent Mount SAE Class 1



The 5585 Series LED minibars provide a compact yet powerful warning solution that offers the flexibility of either permanent or vacuum-magnet mounting. Featuring 12-24 VDC operation, the Reflex® uses high intensity LEDs and reflective technology to maximize light output. Features 18 user selectable flash patterns. This permanent mount model can also be synchronized to operate multiple lights alternately or simultaneously.

- 18 User selectable flash patterns
- 4 Bolt mount
- 12-24 VDC
- Approvals:  
SAE J845 Class I, CE, R10, IP65
- Spares:  
R5500LA Replacement Lens

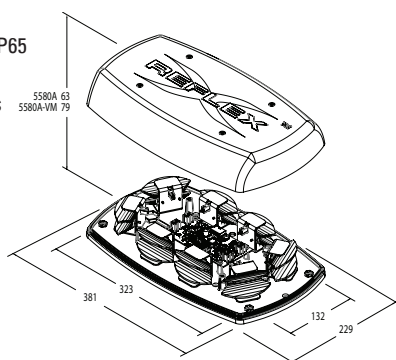

## Permanent Mount

63 H x 381 W (mm)

Part No. 5585A

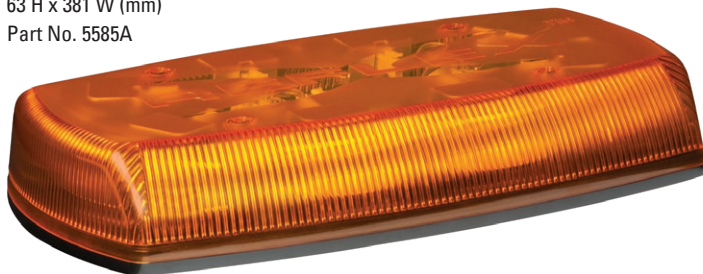

## Vac / Magnetic Mount

79 H x 381 W (mm)

Part No. 5585A-VM

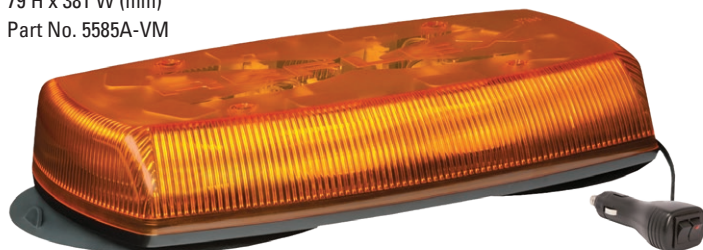

## Mounting Bracket Option

Suits REFLEX &amp; BLAZE lightbars. Part No. REFLEXBKT





## LED LIGHTBARS

### Optilux LED Micro Lightbar 248mm SAE Class 1

The Optilux MLB100 clear mini light bar is a compact, versatile lamp suitable for numerous applications. This LED lamp is characterised by its low profile, and wide variety of flash patterns. 30 high intensity LEDs create a 360 degree light spread while consuming only 2 amps at 12VDC.

The MLB100 is available in fixed mount and magnetic mount, and operates with both 12 and 24 volt systems.

- 23 User selectable flash patterns
- Multiple units can be synchronised
- Weatherproof and vibration resistant
- Fixed or magnetic mount options
- Multivolt 12-24 V DC
- Approvals: SAE Class 1, ECE R65, IP65

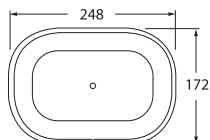

Fixed and magnetic mount

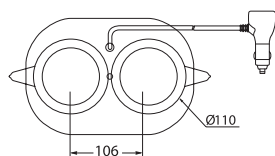

Magnetic mount configuration

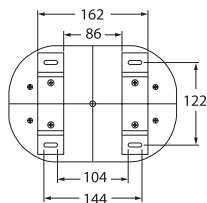

Fixed mount configuration

#### Fixed Mount

63 H x 248 W (mm)

Part No. 7MLB100



#### Magnetic Mount

60 H x 248 W (mm)

3000mm cable with dual button plug

Part No. 7MLB100-MAG

